

Fully Adhered Membrane - Cover Board (RB) - Existing Roof - Concrete (Recover)

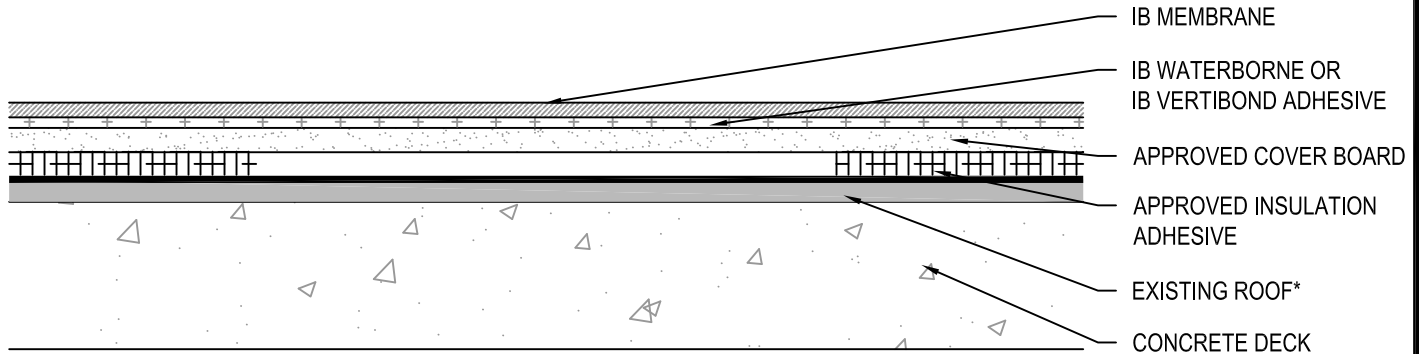

Fire Rating / Max. Slope	Deck Type	Cover Board (over Existing Roof)			IB Membrane Attachment	Max. Design Pressure**
		Type	Insulation Adhesive	Attachment		
<input type="checkbox"/> Class 'A' Unlimited	Structural Concrete	Approved Cover Board	OlyBond 500 (Spotshot) Insulation Adhesive	Four continuous ribbons, Min. 3/4" to 1" wide, 12" o.c.	IB Waterborne or IB Vertibond Adhesive	-120.0 psf (Class 240)
<input type="checkbox"/> Class 'A' Unlimited	Structural Concrete	Approved Cover Board	IB Rapid Set Insulation Adhesive	Four continuous ribbons, Min. 1/2" to 3/4" wide, 12" o.c.	IB Waterborne or IB Vertibond Adhesive	-232.5 psf (Class 465)

Approved Cover Board: Dens Deck Prime, Securock Gypsum-Fiber Roof Board, minimum 1/4" thickness.

*** Existing Roof:** SBS or APP modified, or oxidized asphalt smooth coated, mineral surfaced roofing system.

**** Refer to Substrate Resistance table for required pull-out values.**

For additional information about IB Roof Systems requirements, recommendations, installation details, approvals and limitations for the above assemblies, please refer to the latest edition of the IB Roof Systems Specifications Manual. For Technical Services please contact us at 800-426-1626.

Membranes:	Colors:			Warranties:	Warranty Lengths:
<input type="checkbox"/> 50 Mil Membrane	<input type="checkbox"/> White*	<input type="checkbox"/> Cool Sand*	<input type="checkbox"/> ChemGuard*	<input type="checkbox"/> Total System (NDL)	<input type="checkbox"/> 10 yr (50, 60, and 80 mil)
<input type="checkbox"/> 60 Mil Membrane	<input type="checkbox"/> Gray	<input type="checkbox"/> Green	<input type="checkbox"/> Red	<input type="checkbox"/> Warranty Plus	<input type="checkbox"/> 15 yr (50, 60, and 80 mil)
<input type="checkbox"/> 80 Mil Membrane	<input type="checkbox"/> Tan	<input type="checkbox"/> Brown	<input type="checkbox"/> Custom: _____	<input type="checkbox"/> Commercial Limited Material	<input type="checkbox"/> 20 yr (60 and 80 mil)
	* Meets CRRG, Title-24, & EnergyStar Standards			<input type="checkbox"/> Lifetime Residential Limited Material	<input type="checkbox"/> 25 yr (80 mil)

Submitted By:

Address:
Telephone:

Project Name:

Address:

